

Glossary

Refer to: http://www.webopedia.com/quick_ref/OSI_Layers.asp

Hub – A multi-port repeater containing multiple ports to interconnect multiple devices. A hub operates at level 1 of the OSI Model.

Switch – A multi-port device that logically subdivides a network into smaller individual segments. A switch operates at level 2 of the OSI Model.

Router – A multi-port device that can connect dissimilar networks running at different transmission speeds and using a variety of protocols. A router operates at level 3 of the OSI Model.

Server – A computer on the network that manages shared resources.

Firewall – A specialized device that selectively filters or blocks traffic between networks.

DHCP Server – A computer that assigns and manages IP addresses on a Network.

DNS Server – A computer that manages shared databases of domain names and their addresses.

DMZ – A demilitarized zone, a network separate from your local area network that is used to connect servers that need to be accessed by the outside world. (Mail and Web servers).

Cat. 3 Cable – Twisted pair cable capable of transmission speeds of up to 10 Megabits per second.

Cat. 5 Cable – Twisted pair cable capable of transmission speeds of up to 100 Megabits per second.

Cat. 5e Cable – An Enhanced version of Cat. 5 cable providing improved noise reduction and transmission speed of up to 350 Megabits per second.

Rules to remember:

1. Twisted pair cable can not be run farther than 100 meters or 328 feet.
2. Every device on a network needs a unique address to communicate.
3. Addresses can be assigned manually or automatically (DHCP).
4. The local area network (LAN) should sit behind a firewall.
5. Any server that needs to be accessed by the outside world should be placed on a DMZ.
6. A router can be used to connect your local area network to the outside world via an Internet connection. (T1, DSL)
7. A DNS server is used as a "phone book" to link hard to remember I.P. addresses to easy to remember URL's.

Networking Icons



Hub



Switch



Router



Wireless Router



File Server



Web Server



Firewall



DHCP Server



DNS Server



DMZ



Network Printer



Network Printer



Desktop Computer



Desktop Computer



Desktop Computer



Desktop Computer



Laptop Computer



Laptop Computer



Laptop Computer



Laptop Computer

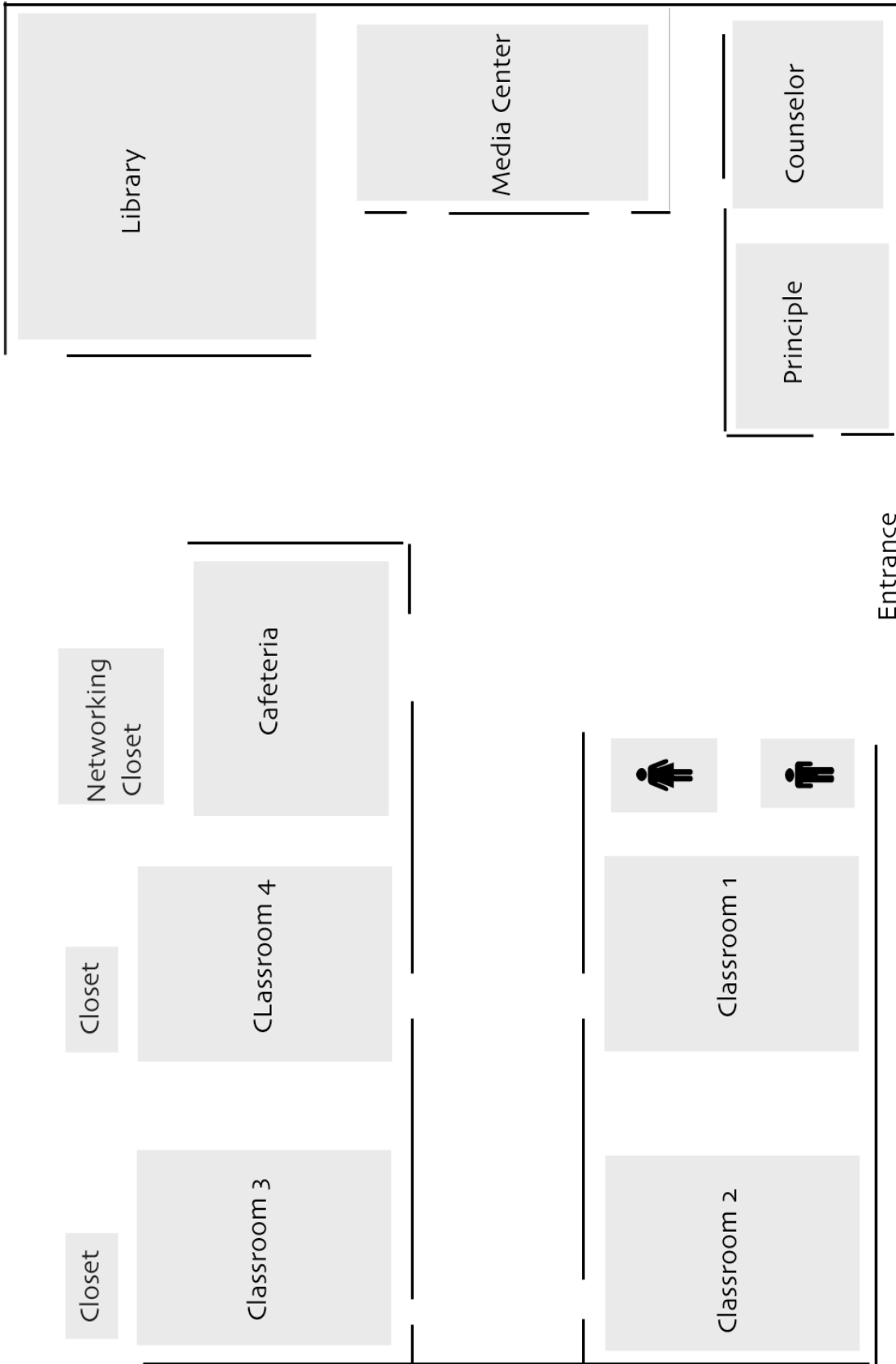

Entrance

